



Allworx[®] Reach[™] and Reach Link[™]

A Complete Business Communication System That Fits in Your Pocket

Always stay connected with Allworx Reach. The Reach mobile app extends the rich functionality of your Allworx VoIP communication system right to your iOS and Android devices. Allworx Reach Link ensures a seamless voice experience, even as your mobile data network changes.

Allworx Reach Highlights

- ✓ Transfer, hold, and park calls with a single touch.
- ✓ Make easy three-way calls.
- ✓ Access call history, see parked calls, and call into scheduled conference calls.¹
- ✓ Search across Allworx system users and extensions, and personal mobile contacts.
- ✓ Check voicemail messages.
- ✓ Change presence setting.

Used by
More Than
89,000
Road Ninjas²

Allworx Reach Link Highlights

- ✓ Keep active Reach calls connected as you move from a Wi-Fi to a 4G cellular data network, and vice versa.
- ✓ Choose from several one-touch options to recover interrupted Reach calls in real time.
- ✓ Control the manual option to keep active 4G Reach calls on 4G, regardless of the Wi-Fi availability.



Reach Link is sold separately as a system-wide license.

Reach is available for iOS and Android smartphones and tablets. One Reach license is included with every Allworx system so you can try it for free. Additional licenses can be purchased in one-, five-, or 10-license packs.

Popular Uses



- Road ninjas who always want to be within reach on their business numbers.
- Legal and health care professionals who need to be reachable without giving out their personal mobile number.
- Employees who work in a distributed work area such as car dealerships, retail showrooms, and schools.

Allworx Reach with Reach Link enabled on iPad and iPhone — Active Call Screens



1. Accessing scheduled calls via Reach is available to Allworx systems that have installed Allworx Conference Center software license key.
2. As of June 2016.

Allworx Reach on iPhone – Contacts and Calls Screens

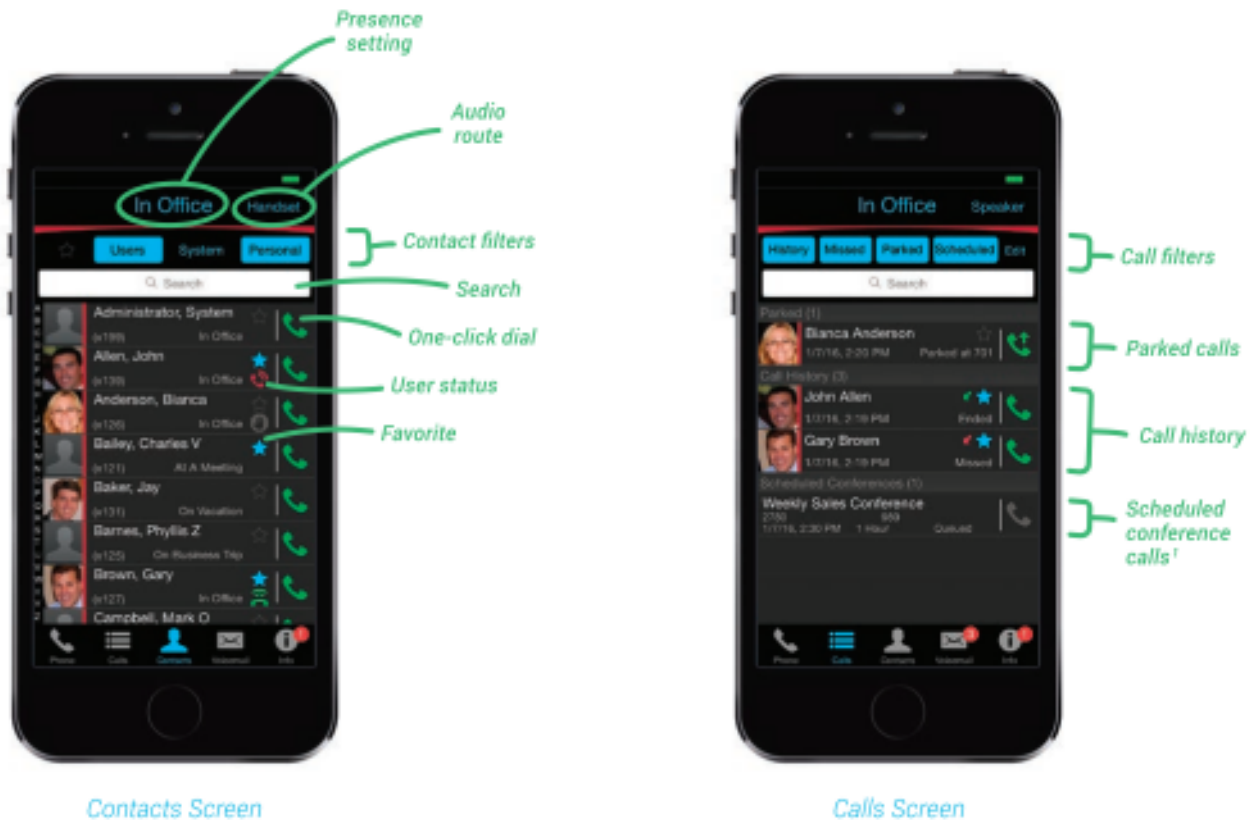

How Allworx Reach Link Works

During active Reach calls

Reach Link automatically connects active calls as the mobile data network changes from 4G to Wi-Fi, and vice versa.

During brief network interruptions

While Reach Link is reconnecting the call, the other party will hear a brief down-tone and an explanation.



¹ Accessing scheduled calls via Reach is available to Allworx systems that have installed Allworx Conference Center software license key.